

Installation instructions: SAGA 300 -sliding door system

- 1 Slide all brackets to the track

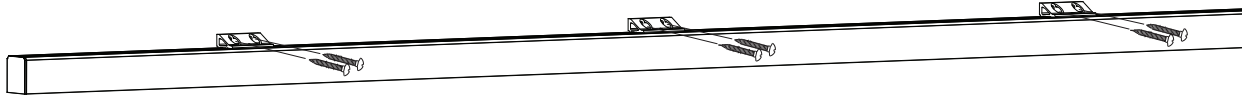

- 2 Mount the track to the wall.



- 3 Slide all the parts to the track:

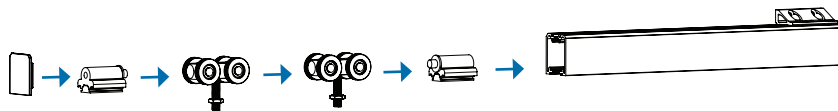

- 4 Attach the plates to the door and insert the bottom guide channel if necessary.

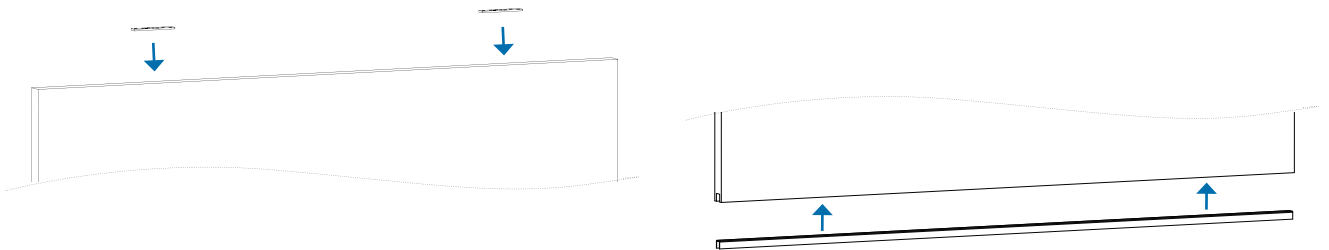

- 5 Screw the support bolts inside the plates. Tighten the nuts on to the plates.

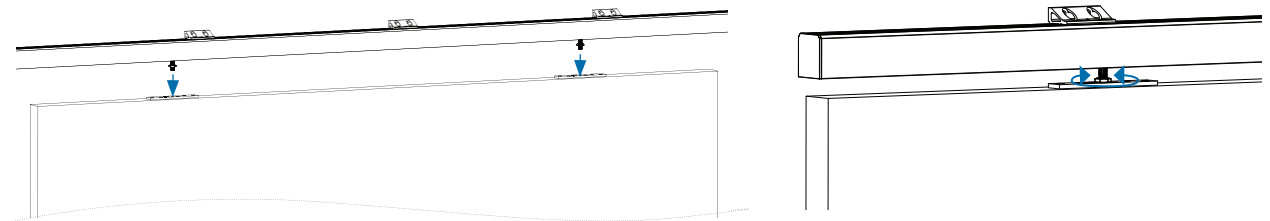

- 6 Install the bottom guide.

