

1. Release the trigger

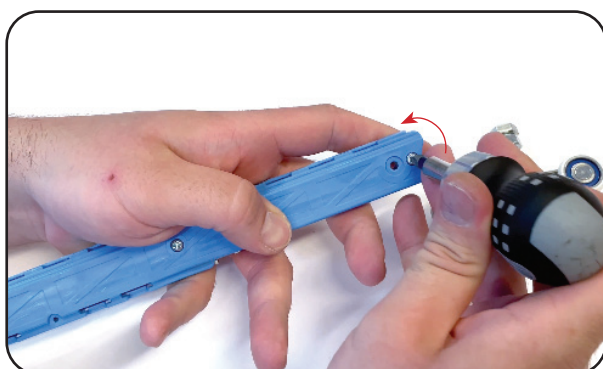

2. Detach the screw from the end of the body.



3. Slightly open the frame. Make sure the "hooks" stay closed on the opposite side.

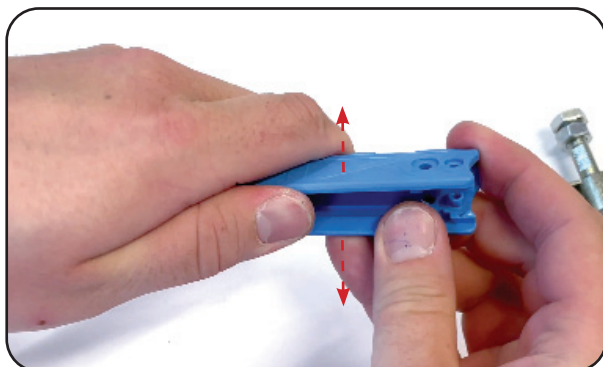

4. Attach the hanger in place ("spearhead" above). Make sure the hanger bolt comes in the right direction i.e. as shown in the picture.



5. Put the screw back in the same place.
Note! Do not over tighten.



6. Slide the trigger to the tuned position.

